

**Go Traffic Management**

This drawing has been produced for a specific client & project identified below and is not intended for use by any other person or for any other purpose. © Go Traffic Management

**Risks**

- Design completed from information provided + google maps desktop risk assessment
- Cone lamps must be used on all road with A speed limit of 40mph or more.

**Notes**

- All signs as per Chapter 8. Distances between cones to be 9m maximum unless otherwise noted.
- Distances between signs NOT to scale for purpose of clarity.
- All sign placement subject to available safe working space.
- The purpose of the Traffic Management Plan is for it to be used only as a guide and all traffic management equipment should be put out according to the 'Safety at Street Works and Road Works - Code of Practice', i.e. Red Book & the 'Traffic Signs Manual Chapter 8', i.e. Yellow Book.
- Signs must be placed in accordance with TSM and the scheme RAMS pack.
- Site conditions may have changed since the design of the drawing any changes which subsequently affect the design need to be reported by the Traffic Management Operative & any changes implemented must comply with Chapter 8.

**Key**

- Sign position and aspect of vision
- Work area
- Diversion Route 1

**FOR CHURCH STREET FOLLOW DIVERSION**

**WRITTEN DIVERSION ROUTE:**

NORTHAMPTON LANE S ↔ MOULTON WAY ↔ A5123 BOOTH RISE ↔ A43 ↔ PSR VIEW ↔ OVERSTONE RD ↔ HIGH ST

**DIVERSION ENDS**

**MINIMUM 0.5m SAFETY ZONE MUST BE ADHERED TO**

**MINIMUM 3.5m SHUTTLE LANE WIDTHS MUST BE ADHERED TO**

Traffic Management must comply with The Safety at Street Works and Road Works Code of Practice

**ROAD SPEED**

**30**

**CROSS SECTION**

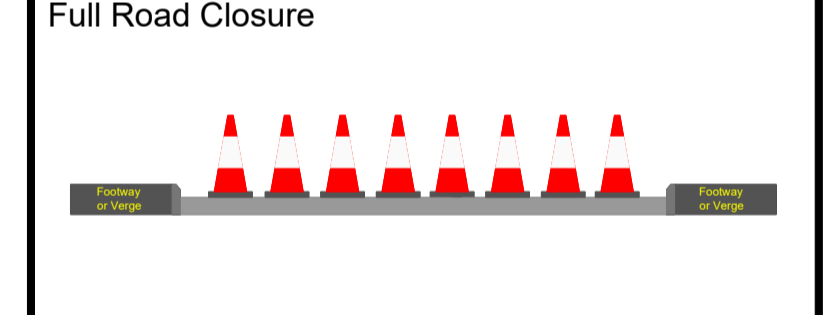

DO NOT SCALE FROM THIS DRAWING.

REV.	DATE	DESCRIPTION
A		AS DRAWN

**GTM**  
Go Traffic Management

Head Office: Go Traffic Management,  
Chaddock Lane, Worsley, Manchester, M28 1XW  
Tel: 0161 351 5370  
www.gtm.co.uk

**CERTIFIED**  
R  
ISO 9001:2015  
ISO 14001:2015

**TRAFFIC MANAGEMENT PLAN**

Client: **Cadent**  
Your Gas Network

Drawing Number: 717904.0001

Drawing Title:  
The Grove, Northampton, NN3 7UF

Design:	Technical Officer:	REV:
Name: K. Noman	M. Gardiner	A
Signature:		
Date: 18/07/23	18/07/23	

